

Explanation of reset mode selection

Function Position	H		HAND		AUTO		A	
Tripping Check	X		○		○		X	
Reset	Hand-Reset		Hand-Reset		Auto-Reset		Auto-Reset	
Contact Condition	97 ○ 98 ○	95 ○ 96 ○	97 ○ 98 ○	95 ○ 96 ○	Dotted line indicates the reset button, is depressed.		97 ○ 98 ○	95 ○ 96 ○
Remarks	Insert screwdriver into the select button, turn it clockwise to the "H" position. 		This product is set in "HAND" position, when shipped from factory. 		Depress the reset button to below ①, insert screwdriver into the select button, turn counter clockwise to the "AUTO" position ②. 		Insert screwdriver into the select button, turn counter clockwise to the "A" position. 	
Setting method								
Remarks	Can't check manual trip when in Hand-reset condition		Normal position for Hand-reset		Normal position for Auto-reset		Can't check manual trip when in Auto-reset condition	

SETTING SCALE

- Reset adjustment for the rated motor current is achieved by turning the set screw.
- Turn the scale until the pointer is set at the rated current value of the motor.
- Turning range is 300°.

Set screw for adjusting the current values

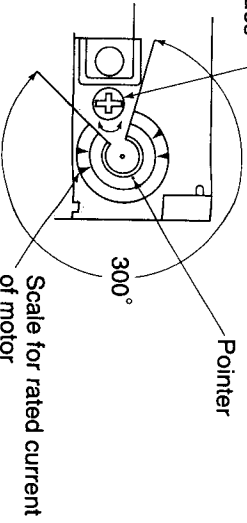

DIMENSIONS

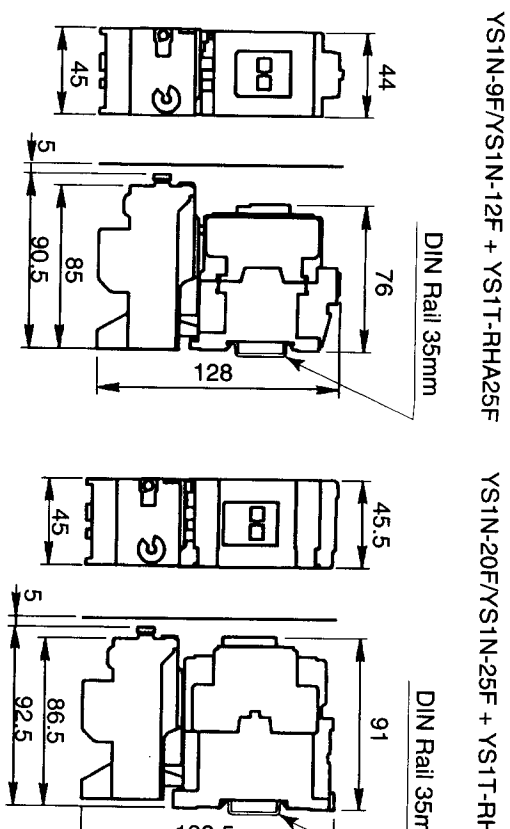

International Sales Offices

United States
IDEC Corporation
 1175 Elko Drive
 Sunnyvale, CA 94089-2209 USA
 Tel (408) 747-0350
 Fax (408) 747-0350
 Toll Free (800) 282-IDEC
 E-mail: sales@idc.usa.com
 Tel/Fax (408) 632-6346
 E-mail: ussales@idc.com

Canada
IDEC Canada Limited
 Eastern Regional Office
 Unit 22-151 Brunel Road
 Mississauga, Ontario, L4Z 1X3, Canada
 Tel (905) 890-9561
 Fax (905) 890-9562
 E-mail: sales@ca.idc.com

Germany
IDEC Elektrotechnik GmbH
 Wendenstraße, 331
 D-20537 Hamburg, Germany
 Tel (040) 251191
 Fax (040) 2543361
 E-mail: service@idc.de

China
IDEC (Shanghai) Co., Ltd.
 Room No. 1401, Silvercoor
 30 Canton Road, Tianshihailu
 Kowloon, Hong Kong
 Tel 2376-2823
 Fax 2376-0790

Japan
IDEC Isumi Corporation
 7-31, Nishi-Miyahara
 1-Chome, Yodogawaku
 Osaka 532-8550, Japan
 Tel (06) 6598-2571
 Fax (06) 6592-9731
 E-mail: idc@idc.jp
 www.idc.jp

Australia
IDEC Australia Pty. Ltd.
 213 Mason Ct, Rowville, Victoria 31
 Toll Free (1800) 88-4332 Fax (03)
 E-mail: sales@au.idc.com